



Woking Borough Council

Woking Site Allocations Development Plan Document (DPD)

Schedule of Proposed Proposal Map Modifications to the Regulation 19 consultation document, including further proposed modifications as a result of the consultation on the Main Modifications

August 2021



Produced by the Planning Policy Team

For further information please contact:

Planning Policy, Woking Borough Council, Civic Offices, Gloucester Square, Woking, Surrey, GU21 6YL. Tel: 01483 743871. Email: planning.policy@woking.gov.uk

Schedule of Proposed Proposal Maps Modifications to the Regulation 19 Consultation Site Allocations DPD

All page, policy and paragraph references refer to the Woking Borough Council Site Allocations Development Plan Document and Proposals Map, Regulation 19 Consultation version, published for consultation on 5th November 2018. The examination reference for the DPD is WBC/SA/001, and the Proposals Map is WBC/SA/001A.

The Proposals Map is not defined in legislation as a development plan document, and the Inspector therefore has no powers to recommend main modifications directly to it. However, a series of modifications have been made to the map as it illustrates geographically the application of policies in the Site Allocations DPD. These modifications have been listed in the schedule below.

Modification reference	Site allocation reference in Regulation 19 document	Reason for modification	Modification to Proposals Map
PMM1	N/a	Update	Update base OS map on the Proposals Map.
PMM2	Various	Update	Amend proposal site labels where relevant to reflect modified policy references.
PMM3	UA23: Elmbridge House	Updated site history	Remove site from Proposals Map.
PMM4	UA34: Coal Yard/Aggregates Yard <i>(proposed to become UA33)</i>	Accuracy, in response to comment	Amend site boundary in accordance with the proposed boundary supplied with representation (see Appendix A illustrating new site boundary).
PMM5	UA36: Land at Bradfield Close and 7 York Road	Following Inspector's recommendation during the Examination in Public. The allocation as set out is neither deliverable not developable, and therefore is neither a justified nor an effective policy.	Remove site from Proposals Map.
PMM6	UA37: Owen House and The Crescent, Heathside Crescent <i>(proposed to become UA35)</i>	Updated Site History	Amend site boundary – remove Owen House (see Appendix B illustrating new site boundary).
PMM7	SA1: Overall policy framework for land released from the Green Belt for development	Following Inspector's recommendation	Add the site boundary for Stable Yard, Guildford Road (see Appendix C illustrating the site boundary). Remove the Green Belt shading from the area contained within this site and re-designate it as Urban Area.
PMM8	SA1: Overall policy framework for land released from the	Following Inspector's recommendation	Add the site boundary for Land to the South of Gabriel Cottage, Blanchards Hill (see Appendix D illustrating the site boundary).

	Green Belt for development		Remove the Green Belt shading from the area contained within this site and re-designate it as Urban Area.
PMM9	SA1: Overall policy framework for land released from the Green Belt for development	Following Inspector's recommendation	On the Proposals Maps (Insets), add Insets '11. Stable Yard' and '12. Land to the South of Gabriel Cottage/Hillview' (see Appendix E) Consequentially, update the key for the Proposals Maps (Insets) to include 'Zone A of the Thames Basin Heath Special Protection Area – CS7, CS8' and 'Ancient Woodland – CS7, CS8' (See Appendix E)
PMM10	GB7: Nursery land adjacent to Egley Road, Mayford	Following Inspector's recommendation during the Examination in Public. The policy is unjustified.	Remove purple hatching denoting allocated open space from the north of the site (referred to as the 'area of local separation' in the DPD). Remove 'Allocated Open Space Site' from the key.
PMM11	GB9: Land adjacent to Hook Hill Lane, Hook Heath	Following Inspector's recommendation during the Examination in Public. The policy is unjustified.	Remove site from Proposals Map, and remove 'Safeguarded Open Space Site' from the key.
PMM12	GB10: Land surrounding West Hall, Parvis Road, West Byfleet (<i>proposed to become GB9</i>)	Following Inspector's recommendation during the Examination in Public. The allocation must include a location plan for the Traveller's Site.	Include new sub-site of 1.72ha labelled 'GB9A' within the site boundary to reflect extent of the allocated Traveller site (see Appendix F illustrating new sub-site).
PMM13	GB13: Brookwood Farm SANG	Accuracy, in response to comment	Amend site boundary in accordance with correct extent of SANG land (see Appendix G illustrating new site boundary)
PMM14	GB17: Woking Palace, Carters Lane, Old Woking	Following Inspector's recommendation during the Examination in Public. The policy is unjustified.	Remove designated 'Allocated Heritage Parkland' site, and replace with an amended site boundary depicting land within Council ownership only (see Appendix H illustrating new site boundary). Remove 'Allocated Heritage Parkland' from the key.
PMM15	GB18: West Byfleet Junior and Infant School Playing Fields (<i>proposed to become GB11</i>)	Clarity	Remove purple hatched area of 'Allocated Open Space'; designate only the school playing fields as 'Urban Open Space' and the school buildings as 'Urban Area' (see Appendix I illustrating new extent of designation).
PMM16	N/a	Update	Amend Green Belt boundary to align with Policy SA1 (see Appendix J illustrating revised boundary)

Appendix A: Revised plan of site UA34 (proposed to become UA33): Coal Yard/Aggregates Yard adjacent to the railway

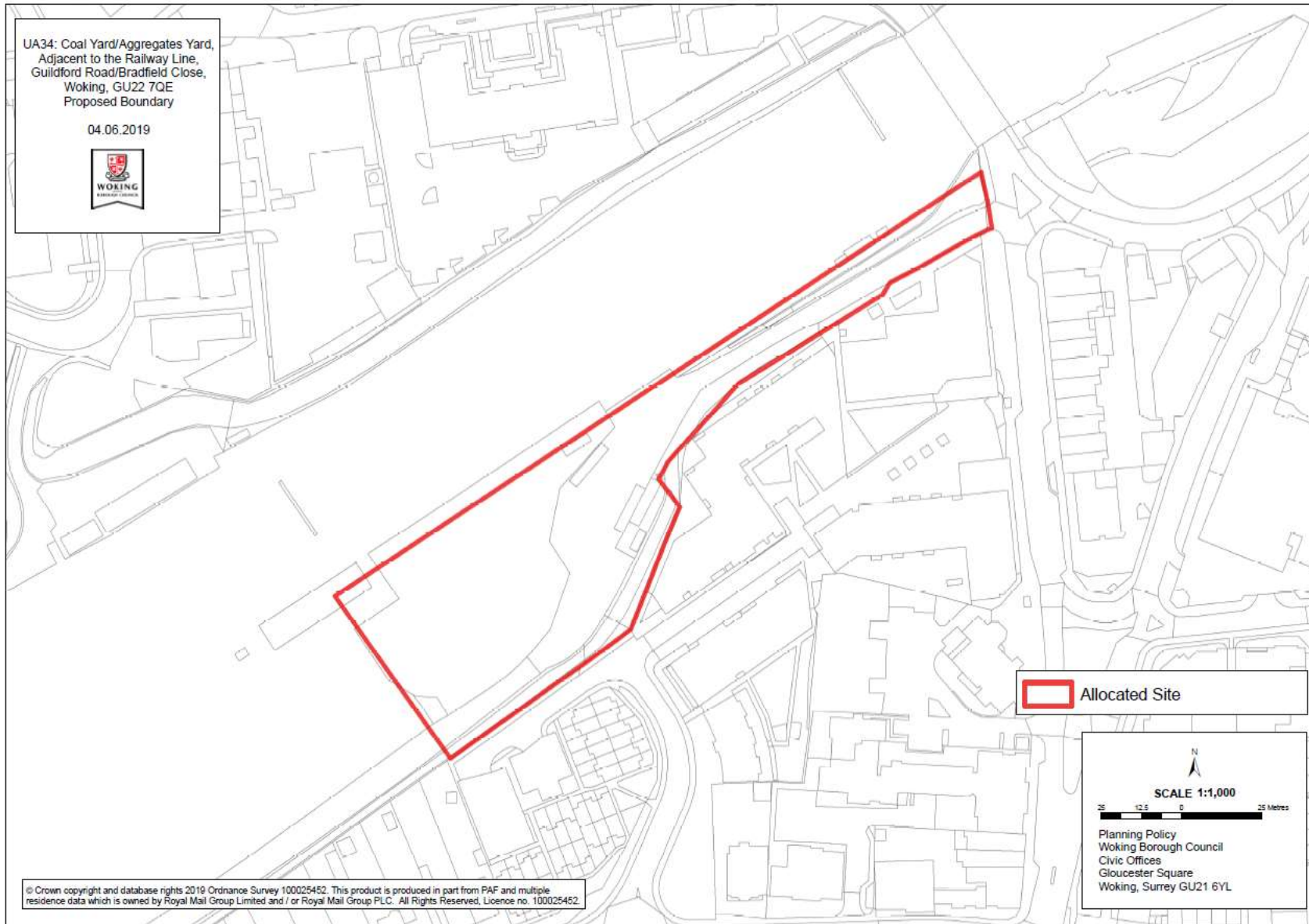

Appendix B: Revised plan of site UA37 (proposed to become UA35): The Crescent, Heathside Crescent

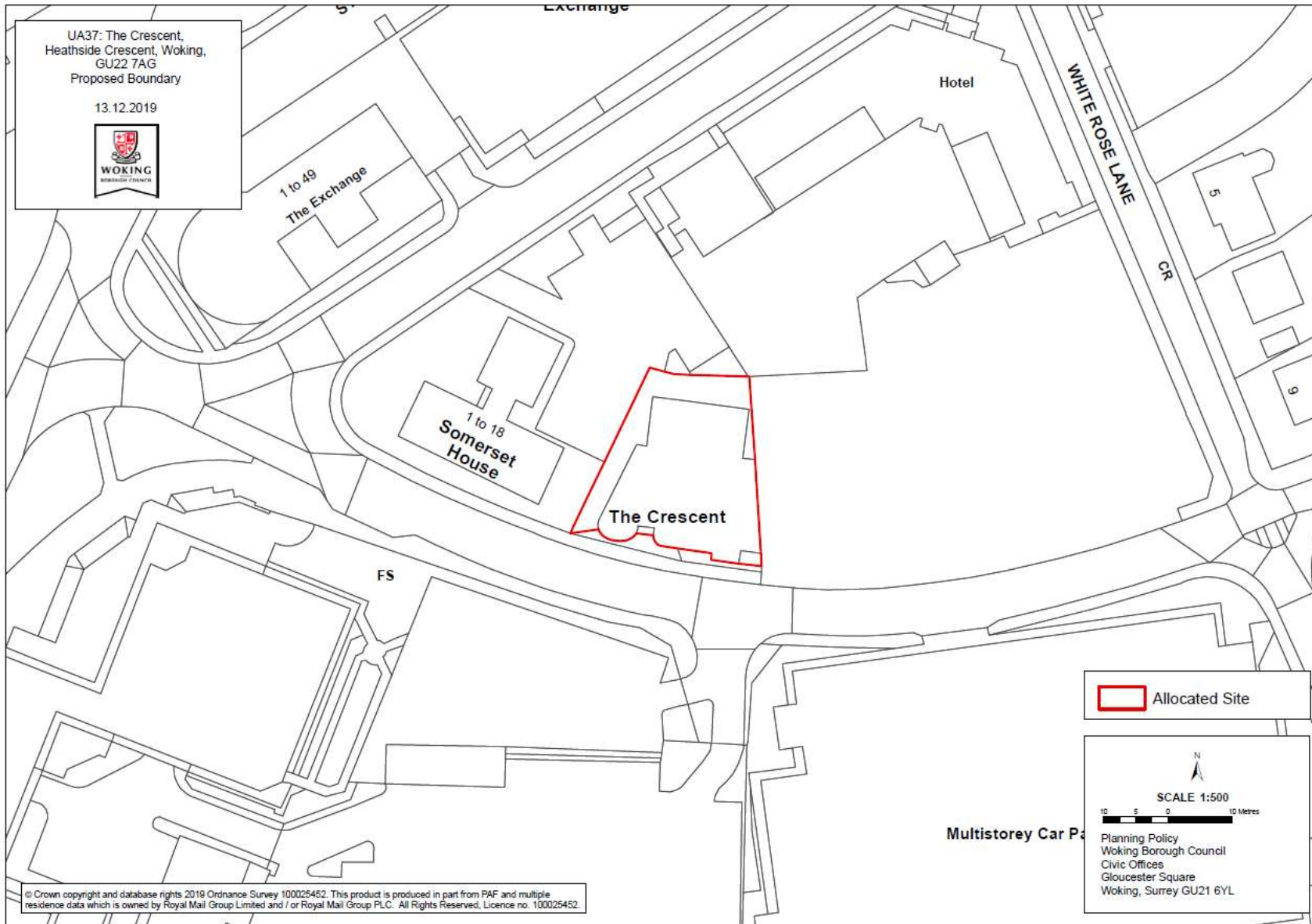

Appendix C – Site plan for Stable Yard, Guildford Road



Appendix D – Site plan for Land to the South of Gabriel Cottage/Hillview, Blanchards Hill

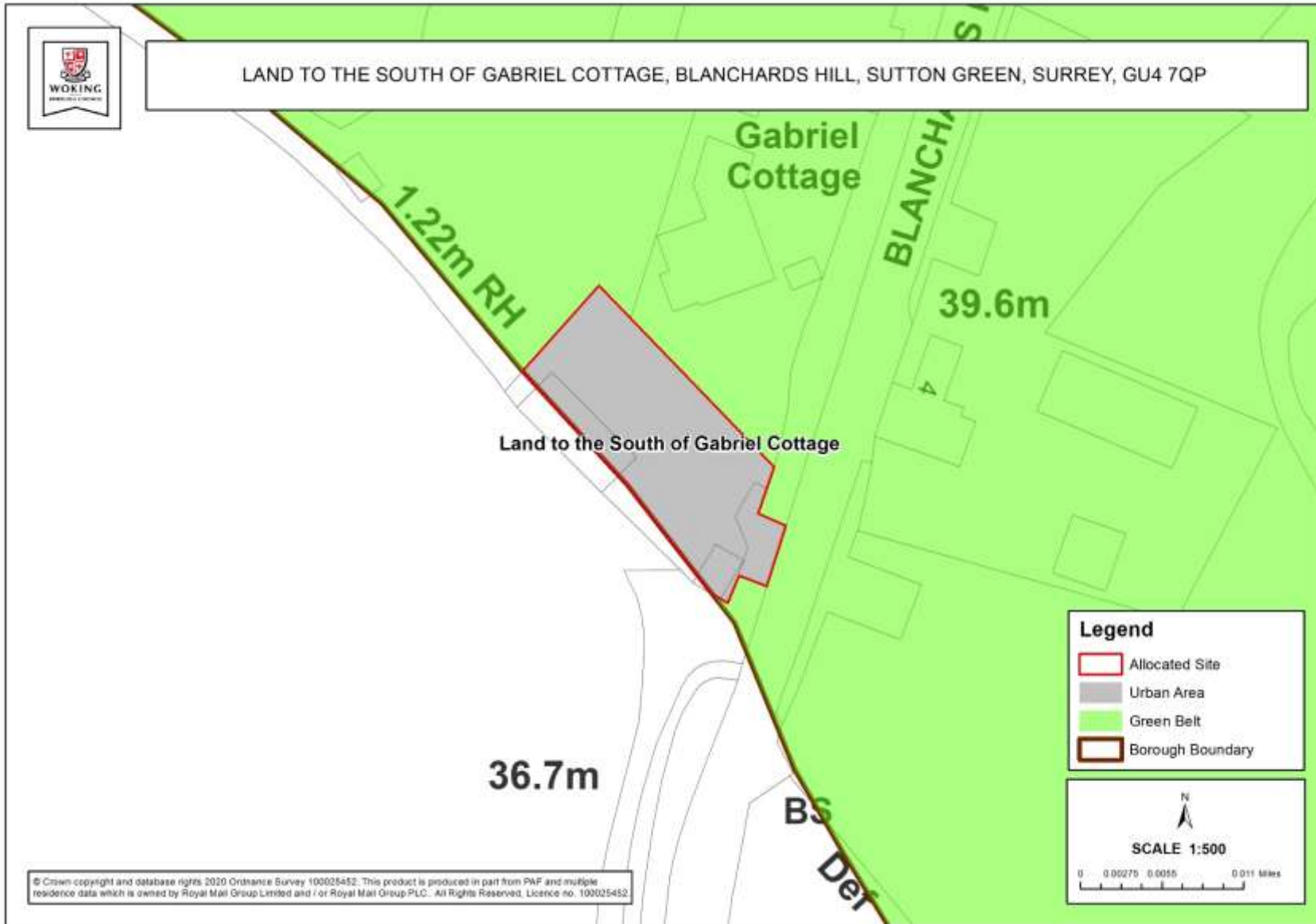

Appendix E: Inset Maps 11 and 12 and Updated Key



11. Stable Yard



12. Land to the South of Gabriel Cottage/Hillview

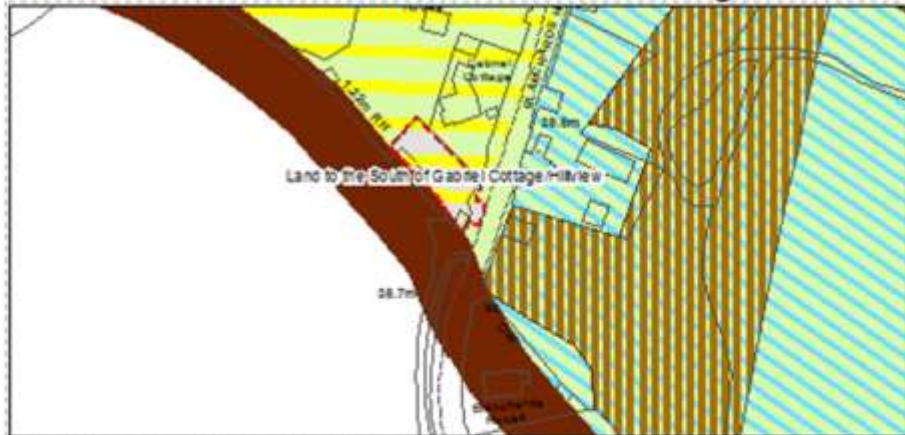

KEY	POLICY NUMBERS	
	Borough Boundary	
	Green Belt	CS1, CS6
	Zone A of the Thames Basin Heaths Special Protection Area	CS1, CS5
	Site of Nature Conservation Importance	CS7
	Ancient Woodland	CS1, CS6
	Common Land	CS17
	Geopaidment and Rising Ground of Landscape Importance	CS24
	Urban Open Space	CS17
	Canal Corridor	DU4
	Urban Area	CS1
	Employment Area	CS15
	High Density Residential Area	CS10
	Major Highway Improvement Scheme	CS18
	Neighbourhood Centre	CS1, CS4
	Local Centre	CS1, CS4
	District Centre	CS2, CS3
	Town Centre	CS1, CS2
	Primary Shopping Area	CS2, CS3
	Primary Shopping Frontage	CS2
	Secondary Shopping Frontage	CS2
	Shopping Parade	CS1, CS4
	Conservation Area	CS20, DU20
	Area of High Archaeological Potential	CS20
	Suney/Warke Plan (2005) Site	
	Suney/Warke Plan - Rail Aggregate Depot	
	Suney/Warke Plan - Concrete Aggregate Sequestered Site	
	Allocated Site	CS1, CS6, CS10
	Allocated SAUG Site	CS6, CS17
	Infrastructure Site	CS18
	Sequestered Site	CS6, CS17
	Heritage Sites to be Prepared	CS6, CS17, CS20

SCALE: 1:2500

0 25 50 100 200 Metres

Planning Policy
Woking Borough Council
Civils Office
Gloucester Square
Woking, Surrey GU24 0YU

© Crown copyright and database rights 2021 Ordnance Survey 100025452. This product is produced in part from PAF and multiple residence data which is owned by Royal Mail Group Limited and / or Royal Mail Group PLC. All Rights Reserved, Licence no. 100025452.

Appendix F: Revised plan of site GB10 (proposed to become GB9 and GB9A): Land surrounding West Hall

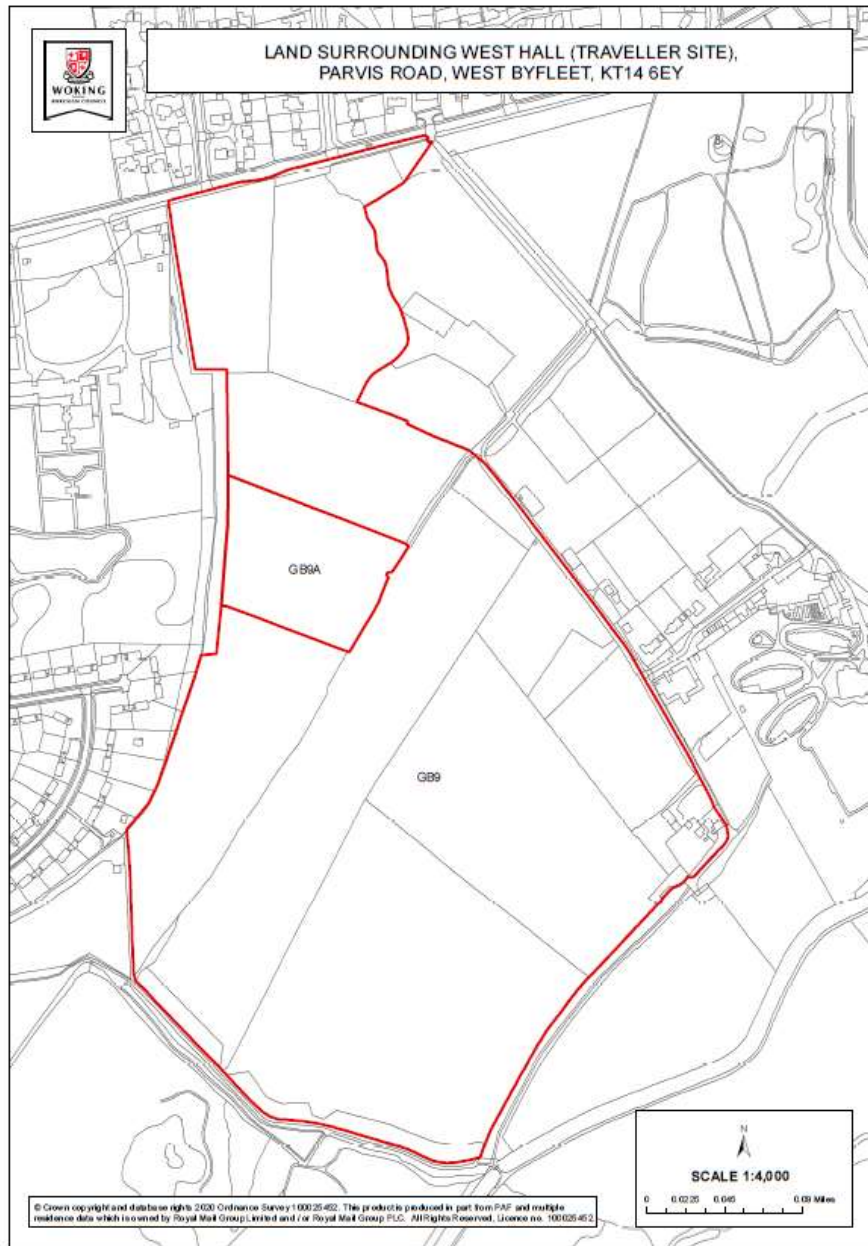

Appendix G: Revised plan of site GB13: Brookwood Farm SANG

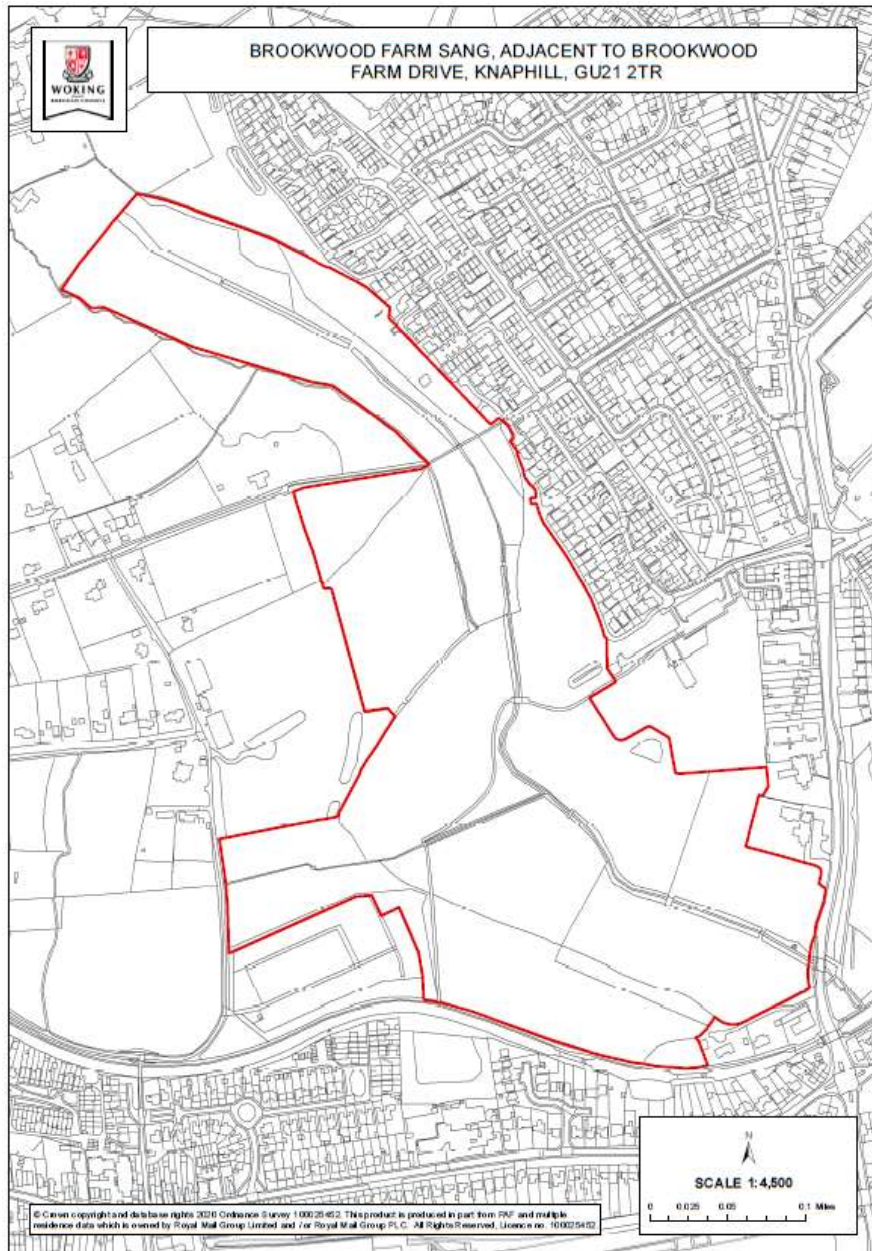

Appendix H: Revised plan of site GB17: Woking Palace, Carters Lane, Old Woking

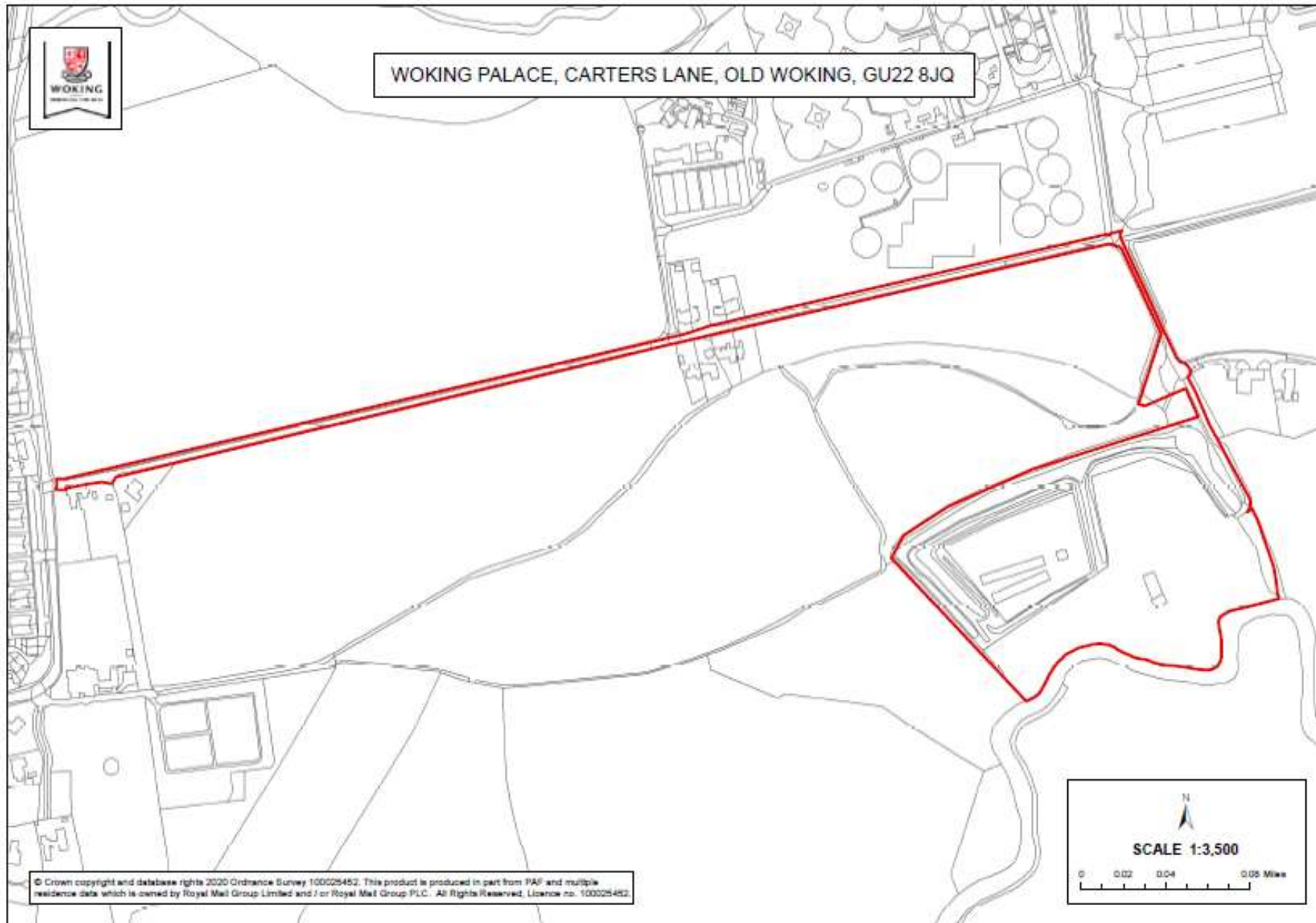

Appendix I: Revised plan of site GB18 (proposed to become GB11): West Byfleet Junior and Infant School Playing Fields, Parvis Road, West Byfleet

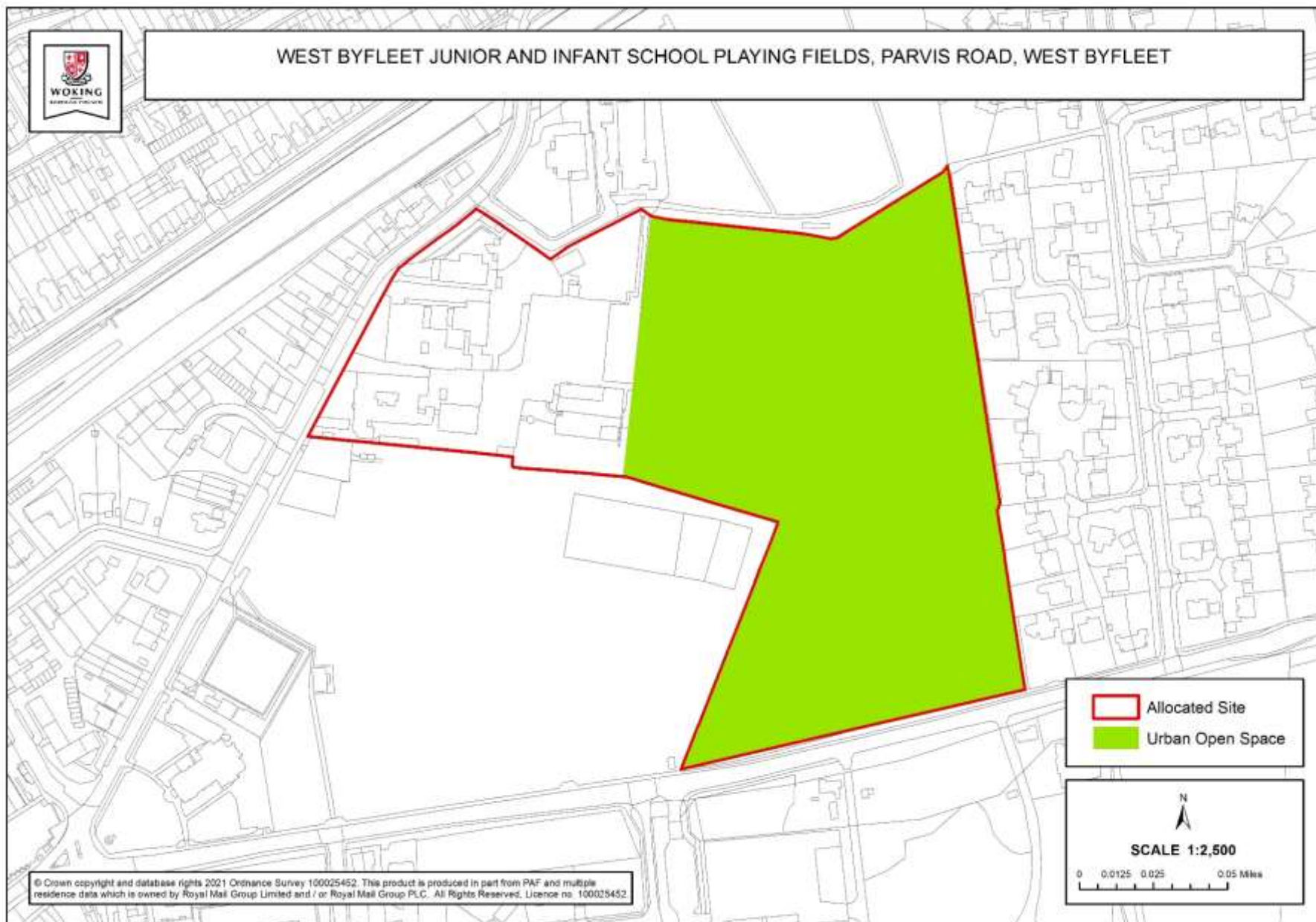

Appendix J: Revised Green Belt boundary

